

Outdoor Signage

OHB-S, OHA-S, OHA series

Deliver bright and brilliant messages, built for the outdoors



Vivid and versatile display demand on the rise

The role of displays has expanded across industries, with digital boards now trending as an alternative to static images, particularly in outdoor environments such as drive thrus, gas and EV charging stations, and even signposts. Content in these environments must be visible even under bright light, while also remaining stable and durable against a variety of tough conditions for optimized business performance. The right digital signage not only provides a higher level of customer experience, but also maximizes operational efficiency through flexible signage management for an optimized solution.

Outdoor optimization for your business with Samsung outdoor signage



High visibility for clear, more concise communication

Businesses can deliver active product promotions with clear visibility in any bright external lighting conditions*, regardless of whether it's day or night. This enables customers to make the best possible choices, ensuring a satisfactory experience to create future sales opportunities.

* This is the result of testing based on outdoor environmental conditions of 10,000 lux or higher.



Flexible and robust hardware to enhance any business

Outdoor displays require certification to ensure they can perform in a variety of conditions, from snow and rain, to strong sunlight and even external physical impact. Typically, providing this robust durability requires bulky hardware, but Samsung's OHB-S, OHA-S and OHA series offer a slim design that blends well in a variety of outdoor environment.

* IP56 (Ingress Protection Rating): Degrees of protection provided by enclosures (IEC 60529)

* The IK European strength test rating uses a 0-10 scale (where 10 indicates the highest possible protection) to measure the degree of resistance against external impact.



Reliable and advanced software for effective management

Stable content playback is enabled by Tizen, while real-time, seamless display operation is made possible with MagicINFO CMS. As a result, promotions and content throughout a network of signage can be effectively adjusted according to the time and place, reinforced by strong security that protects against external threats such as hackers.

Eye-catching visuals from everywhere



Clear and vivid anytime, anywhere Newly upgrade

The OHB-S, OHA-S and OHA are UL-verified for outdoor visibility and offers brightness levels greater than 3,500nits. The Samsung outdoor signage's 24/7 performance delivers crisp and vivid content with a built-in auto-brightness sensor, which automatically adjusts the brightness based on any external lighting for a versatile and operationally efficient display.

* Images and enclosure are simulated and for illustration purpose only.

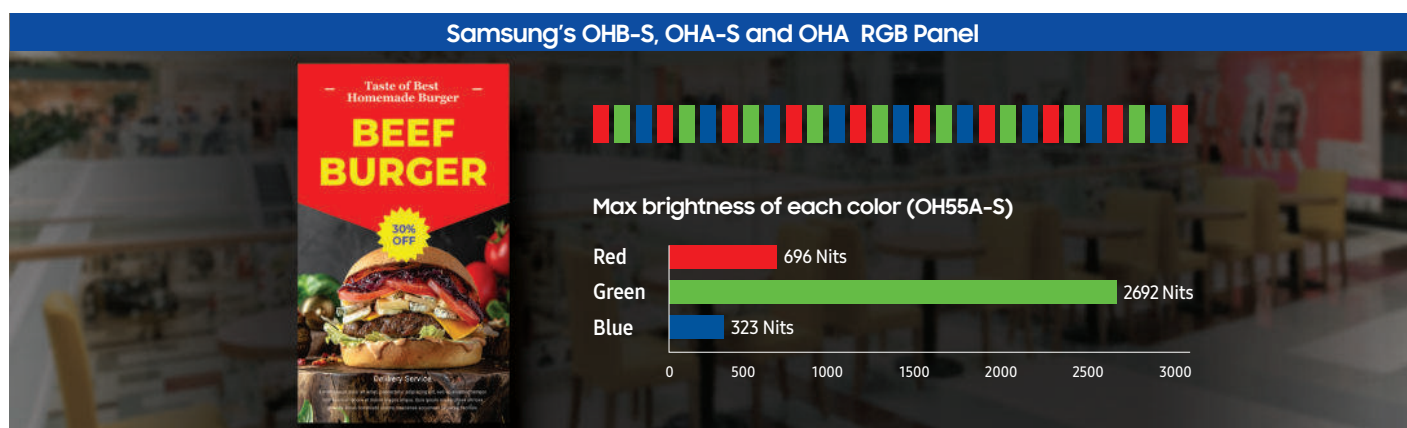

Bright and vivid colors for accurate communication and delivery

The OHB-S, OHA-S and OHA series deliver advanced color accuracy and brightness, creating vivid content through enhanced color reproduction of all red, green and blue shades. With crisp content being what customers now expect, the Samsung outdoor signage's uncompromised picture quality will be sure to capture customer attention.

* The max brightness of each color is based on internal measurements conducted by Samsung.

* The max brightness of each color may vary by model.

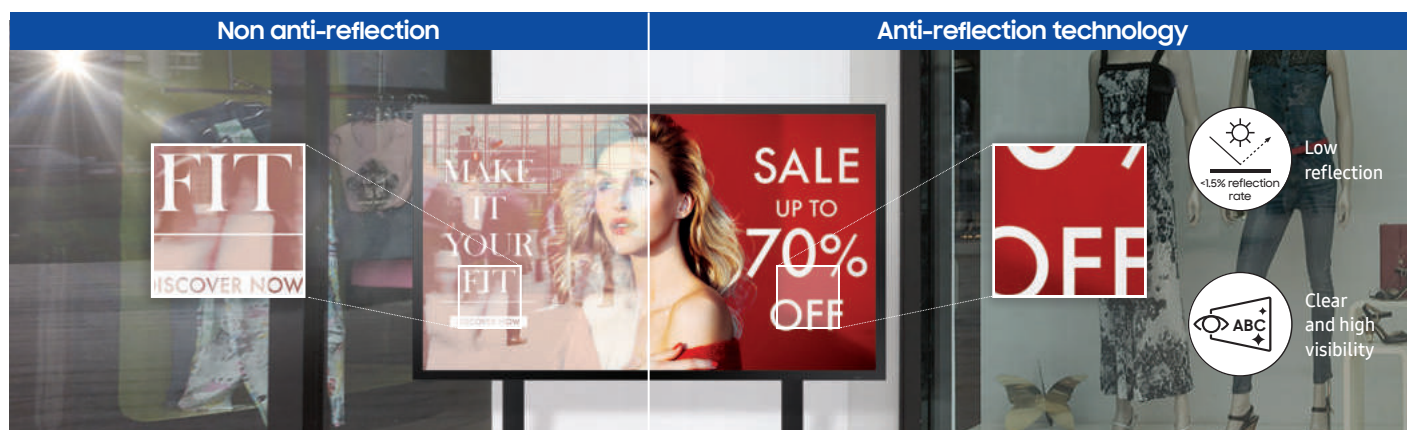

Enhanced visibility with anti-reflection technology

Samsung OH55A-S is enhanced by Magic Protection Glass, which utilizes advanced anti-reflection technology. This innovative solution ensures much better visibility when watching in broad daylight, with a total reflections rate of lower than 1.5%, ensuring clearer images and text for every viewer.

* The total reflection rate is based on internal measurements conducted by Samsung.

* The total reflection rate may vary by model.

Designed with durability in mind



Optimized protection in a variety of outdoor conditions

With certified IP56-rated protection, OHB-S, OHA-S and OHA deliver robust reliability to withstand physical impact as well as dust and water that might affect the display. This ensures optimized operation in a variety of outdoor conditions for consistent performance.

* IP56 (Ingress Protection Rating): Degrees of protection provided by enclosures (IEC 60529)



Prevent humidity for optimal performance with newly added fans

Newly upgrade

With four newly added, hidden fans in the downside of the display, the OH55A-S reduces concerns around external humidity issues such as condensation. The effective air propelling capabilities of the display by the fans enable seamless operation.

* Newly added fans are only available for OH55A-S and OH46B.



Robust durability for screen safety

Fitted with tempered Magic Protection Glass, the Samsung OHB-S, OHA-S and OHA provide durability that is IK10-rated, ensuring advanced safety and protection against external impact. This ensures the product is safe against unexpected damage, giving store manager better peace of mind.

* The IK European strength test rating uses a 0-10 scale (where 10 indicates the highest possible protection) to measure the degree of resistance against external impact.



Powerful performance with slim design

A slim, all-in-one composition enables easy installation, while long-term performance is ensured through IP56 protection, anti-reflection technology, damage defense and an efficient cooling system. Plus, an integrated power box condenses operational components and supports an ultra slim frame.

* "Conventional" refers to Samsung's OHD series.

* IP56 (Ingress Protection Rating): Degrees of protection provided by enclosures (IEC 60529)

* The IK European strength test rating uses a 0-10 scale (where 10 indicates the highest possible protection) to measure the degree of resistance against external impact.

* Design including depth and bezel size may vary by model.

Optimized performance without compromise



Smooth and seamless content playback

The embedded MagicINFO Player S10, backed by the powerful TIZEN operating system, boosts the overall performance of the display and offers painless content management. This ensures seamless transitions and playback to deliver a better experience for both customers and store managers.

* MagicINFO license must be purchased separately.

* MagicINFO player version may vary by model.



Powerful, protective security

The OHB-S, OHA-S and OHA series use comprehensive three-layer security protection, powered by Samsung's proprietary Knox technology, supporting application development on the secured platform and minimization of security attacks.

Suitable for various business environments

Samsung's full-outdoor series provides a versatile is suitable for a wide range of business uses. Designed to be visible in a variety of weather conditions, the OHB-S, OHA-S and OHA series provide a versatile and optimized solution for the purpose of advertising, information display, and even menu boards.

OH55A-S, OH46B-S

EV charging station



OH75A

Bus shelter



Sports arena



Shopping mall



Art gallery



Airport



Specifications

Model			OH46B-S	OH55A-S	OH75A
Display Panel	Diagonal Size	Class	46	55	75
		Measured	45.9" / 116.8cm	54.6" / 138.7cm	74.5" / 189.2cm
	Resolution		1,920 x 1,080 (16:9)	1,920 x 1,080 (16:9)	3,840 x 2,160 (16:9)
	Brightness(Typ.)		3,500nit (Peak 4,000nit)	3,500nit (Peak 4,000nit)	3,500nit (Peak 4,000nit)
	Orientation		Landscape / Portrait	Landscape / Portrait	Landscape / Portrait
	Haze		0%	0%	2.5%
	Contrast Ratio (Typ.)		6,000:1	6,000:1	1,200:1
	Type		VA	VA	VA
	Active Display Area		1,018.08(H) x 572.67(V)	1,209.60(H) x 680.40(V)	1,649.664(H) x 927.936(V)
	Pixel Pitch (mm)		0.53 x 0.53	0.63 x 0.63	0.429 x 0.429
	Color Gamut		72%	72%	72%
	Operation Hour		24/7	24/7	24/7
Connectivity / Sound	Input	Video	HDMI 2.0 (2), HDBaseT	HDMI 2.0 (2), HDBaseT(LAN Common)	HDMI 2.0 (2)
		HDCP	HDCP 2.2	HDCP 2.2	HDCP 2.2
		Audio	N/A	N/A	N/A
		USB	USB 2.0 x1	USB 2.0 x1	USB 2.0 x1
		Tuner	N/A	N/A	N/A
	Output	Video	N/A	N/A	N/A
		Audio	Stereo mini Jack	Stereo mini Jack	Stereo mini Jack
		USB	N/A	N/A	N/A
	WiFi / BT		N/A	N/A	N/A
	External Control		RS232C(In/Out), RJ45(In/Out), HDBaseT	RS232C(In/Out), RJ45(In/Out), HDBaseT	RS232C(In), RJ45(In)
Mechanical Spec	Dimension (mm)	Set	1,069 x 623.6 x 85	1,260.6 x 731.4 x 85	1,774.8 x 1,053.4 x 130
		Package	1,156 x 713 x 200	1,358 x 845 x 230	1,932 x 1,251 x 367
	Weight (kg)	Set	36	46.1	134
		Package	40.5	52.6	150
	VESA Mount		995 x 500 1,000 x 400 (VESA Bracket Option)	1,186 x 560 (Basic) 1,200 x 400 (VESA Bracket Option)	870 x 1,118.4 (M8 x 4Hole) 260 x 1,118.4 (M8 x 4Hole)
	Bezel Width (mm)		24.9	24.9	59.8
Features	Key		Power-box Integrated, IP56 Outdoor, Built-in MagicINFO Player S10, SSSP 10.0	Power-box Integrated, IP56 Outdoor, Built-in MagicInfo Player S7, SSSP 7.0	Power-box Integrated, IP56 Outdoor, Built-in MagicINFO Player S7, SSSP 7.0
	Internal Player	Operating System	Tizen 6.5 (VDLinux)	Tizen 5.0 (VDLinux)	Tizen 5.0 (VDLinux)
		Processor	Cortex A72 1.7GHz Quad-Core CPU	Cortex A72 1.7GHz Quad-Core CPU	Cortex A72 1.7GHz Quad-Core CPU
		Storage (FDM)	8GB (3.88GB Occupied by O/S, 4.12GB Available)	8GB (3.88GB Occupied by O/S, 4.12GB Available)	8GB (3.88GB Occupied by O/S, 4.12GB Available)

Specifications

Model			OH46B-S	OH55A-S	OH75A
Features	Special	H/W	IP56 IK-10 Polarized Sunglasses Viewable Brightness Sensor Temperature Sensor Kensington Lock	IP56 Rated Simple Enclosure Outdoor Protection Glass(IK-10 Level, Anti Graffiti, Infrared Reduce) Polarized Sun Glasses Viewable in any direction HD Base T for Long Distance Installalling Auto Brightness Control with Ambient Brightness Sensor, Temperature Sensor Clock Battery(80hrs Clock Keeping) Kensington Lock	IP56 Rated Simple Enclosure Outdoor Protection Glass(IK-10 Level, Anti Graffiti, Infrared Reduce) Polarized Sun Glasses Viewable in any direction Auto Brightness Control with Ambient Brightness Sensor Temperature Sensor Clock Battery(80hrs Clock Keeping)
		S/W	Auto Source Switching & Recovery RJ45 MDC MS365 Vmware Google Meet VXPlayer	Auto Source Switching & Recovery RJ45 MDC	Auto Source Switching & Recovery RJ45 MDC
Certification	Safety		60950-1, 62368-1	60950-1, 62368-1	60950-1
	EMC		Class A	Class A	Class A
	Environment		N/A	N/A	N/A
	IP Rating		IP56	IP56	IP56
	Security		N/A	N/A	N/A
Power	Power Supply		AC 100 - 240 V, 50/60 Hz	AC 100 - 240 V, 50/60 Hz	AC 100 - 240 V, 50/60 Hz
	Power Consumption	Max[W/h]	430	530	1,200
		Typical[W/h]	203 ※ IEC 62087 measurement standard	274 ※ IEC 62087 measurement standard	471 ※ IEC 62087 measurement standard
		Sleep mode [W/h]	0.5	Less than 0.5W	Less than 0.5W
Operating Condition	Temperature		-30°C~ 50°C	-30°C~ 50°C	-30°C~ 50°C
	Relative Humidity		10~100% (Non-condensing)	10~100% (Non-condensing)	10~80% (Non-condensing)
Accessories	Included		Quick Setup Guide Warranty Card Power Cord Remote Controller Batteries	Quick Setup Guide Regulatory Guide Warranty Card Power Cord Remote Controller Batteries	Quick Setup Guide Regulatory Guide Warranty Card Power Cord Remote Controller Batteries
	Optional	Stand	N/A	N/A	N/A
		Mount	Sold Separately	Sold Separately	Sold Separately
		Specialty	N/A	N/A	N/A

About Samsung Electronics Co., Ltd.

Samsung Electronics Co., Ltd. inspires the world and shapes the future with transformative ideas and technologies. The company is redefining the worlds of TVs, smartphones, wearable devices, tablets, cameras, digital appliances, medical equipment, network systems, and semiconductor and LED solutions. For the latest news, please visit the Samsung Newsroom at news.samsung.com. For more information about Samsung Smart Signage, visit www.samsung.com/business or www.samsung.com/displaysolutions.

Smart Signage

For more information about Samsung Smart Signage OH46B-S, OH55A-S, OH75A Displays, visit www.samsung.com/business or www.samsung.com/displaysolutions

Copyright © 2022 Samsung Electronics Co. Ltd. All rights reserved. Samsung is a registered trademark of Samsung Electronics Co. Ltd. Specifications and designs are subject to change without notice. Non-metric weights and measurements are approximate. All data were deemed correct at time of creation. Samsung is not liable for errors or omissions. All brand, product, service names and logos are trademarks and/or registered trademarks of their respective owners and are hereby recognized and acknowledged.

Samsung Electronics Co., Ltd.
416, Maetan 3-dong, Yeongtong-gu, Suwon-si, Gyeonggi-do 443-772, Korea

1 Who do I contact for technical support issues?

Contact your Dealer for technical support and consultation. You will need to provide the screen model number, model code, serial number and proof of purchase. This information can be found at the back of the digital signage product or on the back of the Samsung Monitor (if accessible).

The screen model number is the Series along with the size of the monitor. Example PM43H.

The model code has the following format: LS/F/H/T.../EN

The serial number has 15 characters and has the following format: xxxx9xxxxxxxxxx

2 How do I report a defect claim?

In the event of a defect claim, please contact your Dealer from whom you purchased your digital signage product. You will need to provide the screen model number, model code, serial number, purchase date and proof of purchase. The Dealer will document the claim and provide further consultation as to remediation options.

3 Does my digital signage product have a warranty?

The warranty includes a 1-year manufacturer's warranty from date of purchase for the outer hardware which consists of the housing unit. The monitor itself is covered by a Samsung 3-year product warranty for SMART LED Signage. The Samsung warranty takes effect with the first purchase date from an authorized Dealer.

Conditions of the Samsung warranty can be found in the Samsung Warranty Card and at www.samsung.com under section "Support".

4 What is MagicINFO and how can I use it?

Your Samsung monitor is pre-loaded with the MagicINFO App, which is a content management software. With MagicINFO or other content management software you can manage and control the flow of content on multiple devices across multiple locations via remote desktop. The software has built in layouts, widgets, webtools and other creative applications. Playlists and scheduling can be managed across all devices.

Additional fees are required to activate and run MagicINFO. You can download and install the MagicINFO software onto a server or use the cloud-based subscription and activate the user license. The software download is free of charge from the MagicINFO website (www.magicinfoservices.com), but a fee is required for the licenses. Other third-party software programs are also compatible with the Samsung monitors.

5 Where can I find cleaning instructions?

Regular cleaning and removal of dust and debris will help prolong the life of your product. Follow the safety precautions and cleaning instructions as outlined in the Samsung User Manual, which can be found at www.samsung.com under the section "Support". Safety precautions and cleaning instructions are listed in Chapter 1. Safety and subsection Cleaning.

Do not attempt to clean the inside of the Samsung monitor. Contact an authorized Dealer for additional cleaning instructions.

YOUR FIRST STEPS WITH THE DEVICE

1

Plug into socket. Device should automatically turn itself on.



2

Use the remote control to turn the device on/off and to change settings.

3

Insert USB or connect to WiFi to upload and play content.



BASIC SETTINGS



Set your language

Menu > OnScreen Display > Language > English



Check your time and date

Menu > System > Time > Clock Set > Date or Time > Enter the Date or Time



Change your keyboard language

Menu > System > Input Device Manager > Keyboard Language > English



Change picture mode

Menu > Picture > Picture Mode



Change PIN

Menu > System > Change PIN > Enter 0000 > Enter new PIN



Lock your content

Menu > System > Security > Enter PIN (default 0000) > Button Lock > On > Safety Lock On



Lock your device

Menu > System > Security > Enter PIN (default 0000) > Power On Button > On > Safety Lock On

FUTURE OF DIGITAL SIGNAGE IS HERE THE SMART LINE PRODUCT FAMILY

Frameless design providing
a smart & elegant look



Stain and fingerprint
proof matt surface.
Custom branding
available.

New ready to use products with stunning design

Digital Totems, A-Boards & Suspended Panels with
Samsung professional screens and state-of-the-art
frameless design.

**Best sellers ready on stock or produced and
delivered in 3 weeks only.**



SAMSUNG

Ready to use solution incl. professional Samsung screen
ready to operate **24/7/365**.

Touch solution available.



Ready to use with USB and RJ45 connectors

Smart Line Digital A-Board and Suspended Panel

- ready to use solution with built-in professional Samsung screen
- stunning frameless design
- standard colour black or white, other RAL colours on request
- USB socket for simple digital content management and presentation



COMPLETE DIGITAL SIGNAGE PORTFOLIO



■ Shop Window Display ■ Totem with Round Corners ■ Outdoor / Doublesided Totem ■ A Board ■ Kiosk



UPLOADING CONTENT VIA USB MEMORY STICK

1. Find your USB memory stick

Switch on the device > Press the Home button to enter the menu
> Go to the play icon and press Enter> at Int. Memory find your USB stick > Options (right) shows all content options

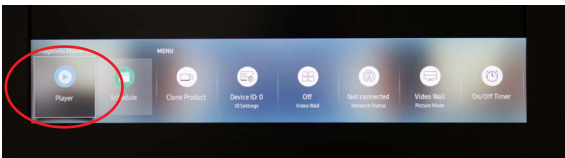

2. Clean up internal storage

We recommend to delete the existing content. Otherwise you will show all existing content in an endless loop.

In the overview of your content in the upper right corner, go to Options > Delete > Enter > select the right file > Delete > Enter

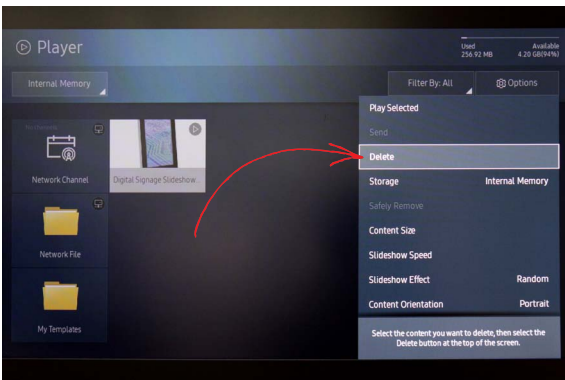

3. Content integraion

Top left select the USB stick > Options > Send > select the correct image / video > Enter > Send > now you see „internal memory“> Enter > Start to play > OK to confirm

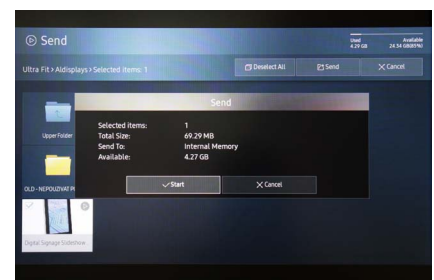
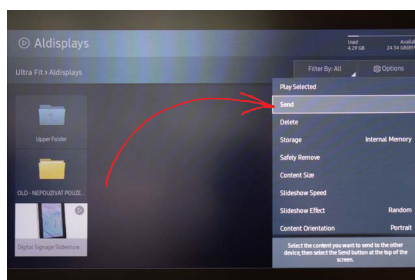
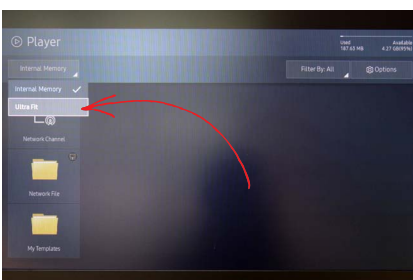

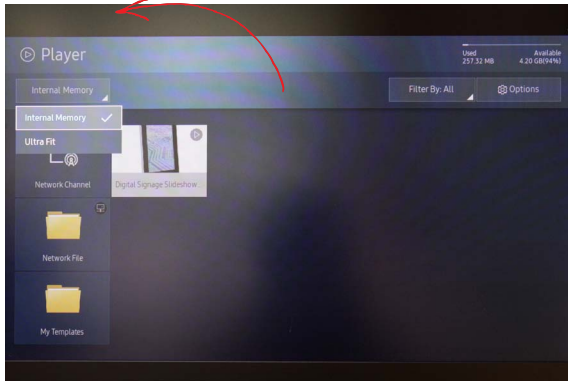

4. Stop and play video files

To stop the video > Cancel > Int. Memory > Select File > Enter

5. Set playing and operating times

If necessary set the correct date and time Menu > System > Time

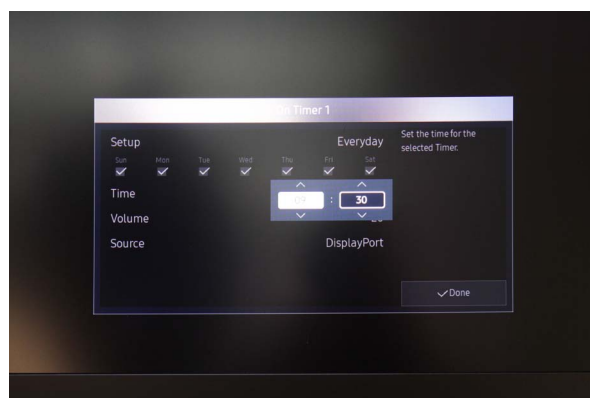
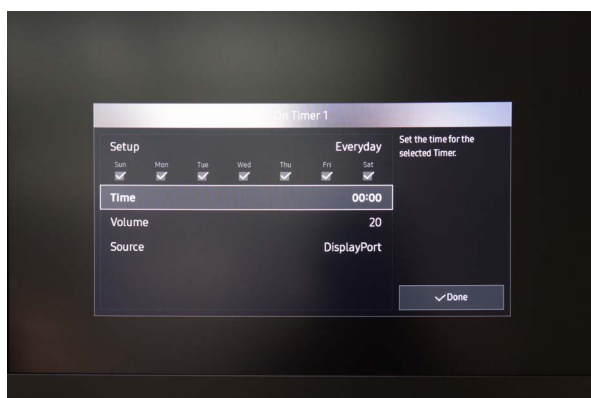
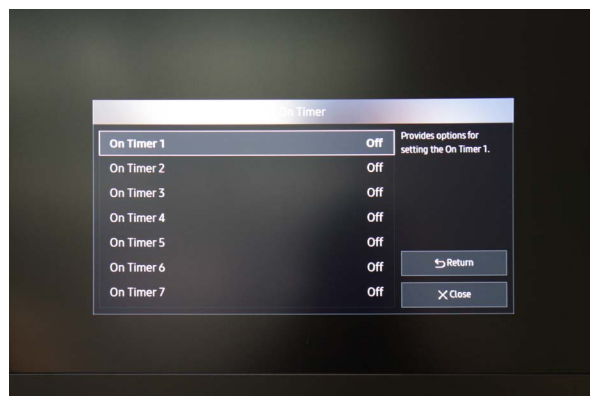

For more detailed information check out the full manual:

https://displaysolutions.samsung.com/pdf/manual/1348/MagicInfo_Express_2.5_Manual_-_Eng_1.2.pdf